



USER MANUAL MMI 2G

Table of Contents

1. ADMISSION.....	2
2. STARTING	2
3. TV OPERATION	3
4. OPERATING THE AUDIO / VIDEO PLAYER	4
5. PARAMETER SETTINGS	5
6. SORTING TV CHANNELS	6

1.Admission

The purpose of this manual is to briefly describe the functions and operation DVB-T digital TV receiver CI-JDVBT-03 in the car. The device is intended for MMI 2G multimedia systems.

CI-JDVBT-03 has two separate modules:

DVB-T module

- Dual-antenna digital terrestrial TV tuner, adapted to work in a car.

Audio / Video player module

- Music and video player which plays files stored on Micro-SD cards and USB flash

The device is fully integrated with multimedia system installed in car and is controlled through buttons from control panel.

2.Startup

The TV starts after press the CD / TV button on the panel operating the MMI unit **1** Pic.1. Device has function to restore last settings, so it will return to last selected TV channel or last played Audio-Video file after startup.



Pic.1

WARNING!

After first startup of device the TV station search function should be run to add new programs to station list. (description: point 3). When programs do not have been added or deliberately deleted on the screen will appear message:

There are no saved stations

3.TV Operation

- **Select and switch TV stations**

Any station from list can be selected using main knob **2** Pic.3 or by buttons: next or previous **3** Pic.3, which are located on control panel.



Pic.2

- **Information about EPG programs**

The device allows you to view information about the current program as well as about the next program **8** Pic.5. The information can be displayed in the form shortened for quick browsing as well as extended "full" format.

To display the information window about EPG programs Pic.5 it necessary to press function button **5** Pic.3 from control panel then select option EPG **7** Pic.4. To close the EPG information window, press the RETURN button **4** Pic.3.

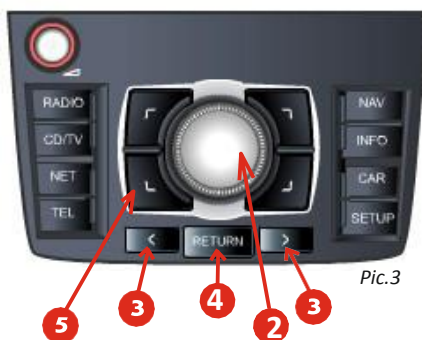

Pic.3

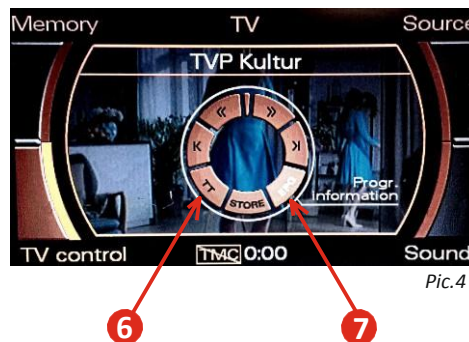

Pic.4

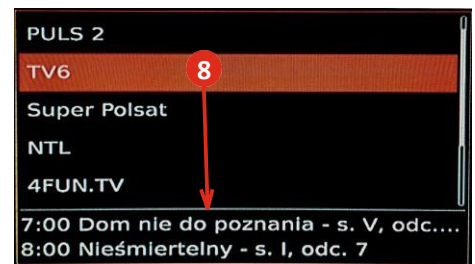

Pic.5

- **Searching and memorizing TV stations**

To start the TV program search function, it necessary to press function button **5** Pic.3 from control panel, then by the central knob select option **6** Pic.4.

The main menu of the device will be displayed on the screen.

In the next steps, select option **9** Pic.6, **10** Pic.7 and the type of scan: MANUAL or AUTOMATIC **11** Pic.8.



Pic.6

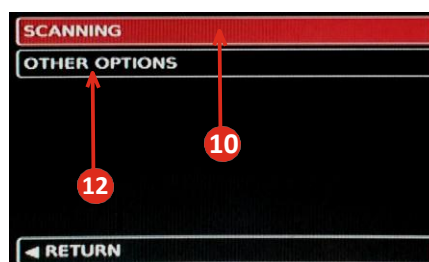

Pic.7

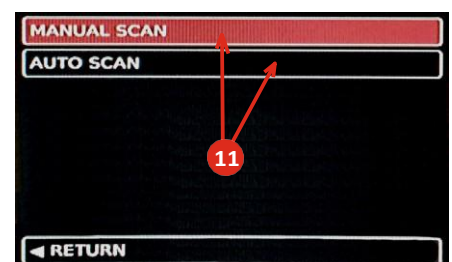

Pic.8

- AUTOMATIC SCAN

When the empty "search" window is displayed, select option **12** Pic.9

The selected function will start the process of "searching" all ranges of frequencies digital terrestrial television automatically. After completing the "scan" a new list station will be automatically saved replacing the previous list. During the "scan" process a window is displayed where you can observe the progress of "scanning" and subsequent attached blocks of programs.

- MANUAL SCANNING

The selected function allows you to search the next frequency ranges individually with the buttons **13** Pic.10. To add the selected program block to the station list, select option **14** Pic.11.



Pic.9



Pic.10

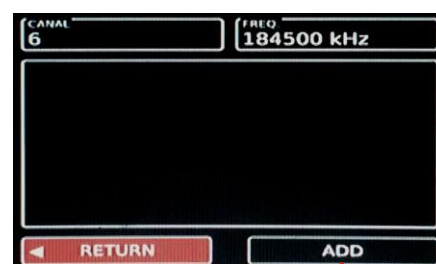

Pic.11

4.Operation of the Audio / Video player

• Selecting the Audio / Video player

To run the audio / video player function to play files stored in uSD or USB it is necessary to press function button **5** Pic.3 from control panel, then by central knob select option **6** Pic.4 in next step select option **15** Pic.12 in main menu.

To change carrier (uSD or USB) select the upper label **14** Pic.13 and confirm by pressing the central knob **2** Pic.3.

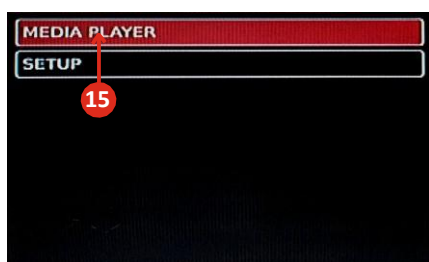

Pic.12



Pic.13

- Operation on catalogs and files

After activating the Media Player function, a window with file browser will show files and directories stored on uSD or USB medium. In the same time Media Player will open carrier with last played music or video file. Structure of files and directories allow to fast browsing and selecting file to play. Files and directories on uSD or USB for playback must be prepared in FAT format.

- Pause start and „scrolling“

The first press of the MMI knob **2** Pic.3 stops the song (Pause) Pic.14.

Pressing the main dial again resumes playing the song Pic.16. Using the lower buttons of the MMI unit **13** Pic.10 allows you to "scroll" the track Pic.15. Again press of central knob resume playback. Using of lower buttons Pic.10 from control panel allow to scroll track. Pic. 15.

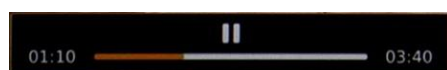

Pauza

Pic.14



„Scrolling“

Pic.15



Play

Pic.16

5.Parameter settings

• Enabling the parameter settings window

To open the parameter setting window, select option **12** Pic.7. The options Pic.17 will appear on the screen.

• Change of parameter settings

By selecting the appropriate option bar using the knob we can change the parameters:

OSD TIME - this parameter set the period of time

for displaying label with informations about selected program after channel switching. Range 0 to 8 sec.

SYSTEM VOLUME - the parameter changes the volume level coming from CI-JDVBT-03 to match the car system, set from 0 to 10.

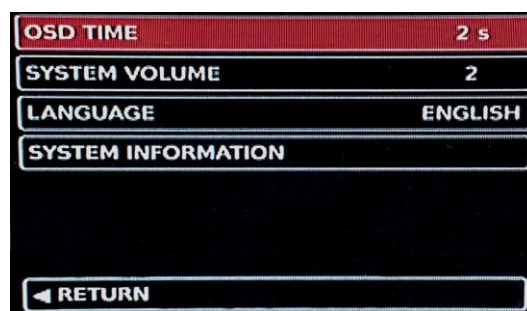

Pic.17

LANGUAGE - the parameter allows you to select the language in which the device displays subtitles and messages, set to Polish, English.

INFORMATION ABOUT THE SYSTEM - the parameter informs about the device's software.

6.Sorting TV channels

The CI-JDVBT-03 module allows the user to change the order of the saved channels. The function is available under the button **15** Pic.18. After pressing the main knob MMI on a specific channel can change its position on the list. Station location confirm by pressing the main knob again.



Pic.18



Pic.19